



# DYNADRILL EQUIPMENT PVT. LTD.

Plot # 2-199, Sai Baba Temple Road, Balanagar, Hyderabad - 500 042, Telangana, India  
 Ph: +91 40 23771243, Cell: +91 94400 48236 / 94406 09036  
 Email: dynadrill1985@gmail.com, info@dynadrillequipment.com Website: www.dynadrillequipment.com



PERRY JOHNSON  
 REGISTRARS, INC.  
 ISO 9001:2008 Registered  
 Certificate No. C2914-0264

## FURY 50

### Shank QL 50 \ 55

Down-the-hole hammer

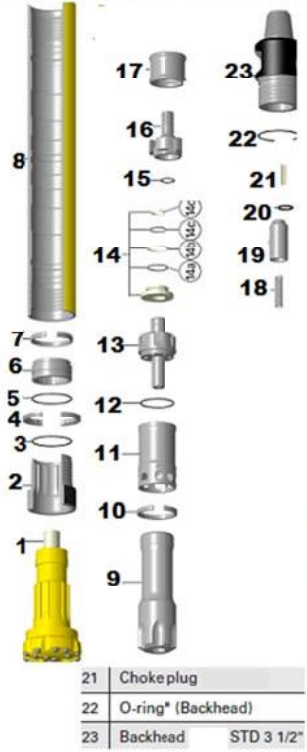

- 1 Exhaust tube
- 2 Chuck QL
- 2 Chuck QL
- 3 O-ring\* (Bit retaining ring)
- 4 Bit retaining rings
- 5 O-ring\* (Bit bearing)
- 6 Bit bearing
- 7 Lock Ring (Bit bearing)
- 8 Casing QL
- 8 Casing QL
- 9 Piston
- 9 Piston QL
- 10 Lock ring (Cylinder)
- 11 Cylinder
- 11 Cylinder
- 12 O-ring\* (Air distributor)
- 13 Air distributor
- 14 Valve assembly .
- 14 Valve assembly
- 14a O-ring (Valve)
- 14b Seal-ring (Valve)
- 14c O-ring (Valve)
- 14d Seal-ring (Valve)
- 15 O-ring\* (Valve cap)
- 16 Valve cap
- 17 Solid spacer
- 18 Spring (Check valve)
- 19 Check valve assembly
- 20 O-ring\* (Check valve)
- 21 Choke plug
- 22 O-ring\* (Backhead)
- 23 Backhead STD 3 1/2"



### General Specifications

	Standard		Quarry	
	English	Metric	English	Metric
Standard drill pipe connection (see options)	3 1/2 API reg pin		3 1/2 API reg pin	
Outside diameter (in & mm)	4.6	117	4.9	124
Length w/o bit shoulder to shoulder (in & mm)	42.0	1067	42.0	1067
Length with bit extended (in & mm)	46.3	1176	46.3	1176
Length with bit retracted (in & mm)	45.3	1149	45.3	1149
Weight w/o bit (lb & kg)	132	60	162	74
Backhead across flats (in)	2 x 3 1/2 AF		2 x 3 1/2 AF	
Minimum bit size (in & mm)	5.1	130	5.5	140
Maximum bit size (in & mm)	6.0	152	6.0	152
Bore (in & mm)	3.7	95	3.7	95
Piston weight (lb & kg)	31	14	31	14
Stroke (in & mm)	3.75	95	3.75	95
Maximum pressure differential (psig & bar)	350	25	350	25
Maximum choke diameter (in & mm)	0.38	9.6	0.38	9.6
Make-up torque (ft-lb & N-m)	5000	6770	5000	6770
Shank style	QL50		QL50	

### Air Consumption:

	QL50/55	
100 psi/ 6,9 bar (scfm & l/s)	202	95
blows per minute	1,116	
150 psi/ 10,3 bar (scfm & l/s)	310	146
blows per minute	1,266	
200 psi/ 13,8 bar (scfm & l/s)	422	199
blows per minute	1,401	
250 psi/ 17,2 bar (scfm & l/s)	538	254
blows per minute	1,521	
300 psi/ 20,7 bar (scfm & l/s)	658	310
blows per minute	1,626	
350 psi/ 24,1 bar (scfm & l/s)	783	369
blows per minute	1,716	
400 psi/ 27,6 bar (scfm & l/s)	911	430
blows per minute	1,791	
435 psi/ 30,0 bar (scfm & l/s)	1,004	474
blows per minute	1,835	