



DYNADRILL EQUIPMENT PVT. LTD.

Plot # 2-199, Sai Baba Temple Road, Balanagar, Hyderabad - 500 042. Telangana, India
 Ph: +91 40 23771243, Cell: +91 94400 48236 / 94406 09036
 Email: dynadrill1985@gmail.com , info@dynadrillequipment.com Website: www.dynadrillequipment.com



PERRY JOHNSON
 REGISTRARS, INC.
 ISO 9001:2008 Registered
 Certificate No. C2914-0264

FURY 80

Shank QL 80

Down-the-hole hammer

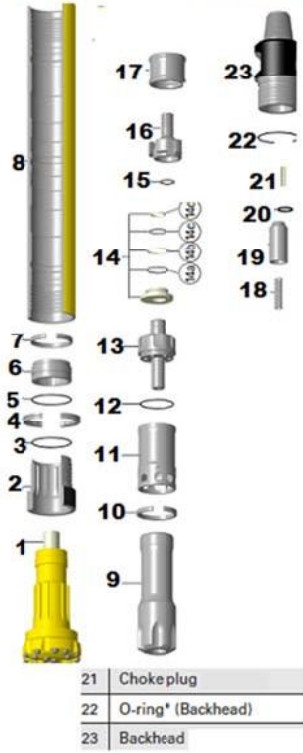

- 1 Exhaust tube
- 2 Chuck QL
- 2 Chuck QL
- 3 O-ring* (Bit retaining ring)
- 4 Bit retaining rings
- 5 O-ring* (Bit bearing)
- 6 Bit bearing
- 7 Lock Ring (Bit bearing)
- 8 Casing QL
- 8 Casing QL
- 9 Piston
- 9 Piston QL
- 10 Lock ring (Cylinder)
- 11 Cylinder
- 11 Cylinder
- 12 O-ring* (Air distributor)
- 13 Air distributor
- 14 Valve assembly
- 14 Valve assembly
- 14a O-ring (Valve)
- 14b Seal-ring (Valve)
- 14c O-ring (Valve)
- 14d Seal-ring (Valve)
- 15 O-ring* (Valve cap)
- 16 Valve cap
- 17 Solid spacer
- 18 Spring (Check valve)
- 19 Check valve assembly
- 20 O-ring* (Check valve)
- 21 Chokeplug
- 22 O-ring* (Backhead)
- 23 Backhead



General Specifications

	Standard		Soft Rock/HF	
	English	Metric	English	Metric
Standard drill pipe connection (see options)	4 1/2 API reg pin		4 1/2 API reg pin	
Outside diameter (in & mm)	7.1	181	7.1	181
Length w/o bit shoulder to shoulder (in & mm)	57.5	1461	57.5	1461
Length with bit extended (in & mm)	63.5	1612	63.5	1612
Length with bit retracted (in & mm)	61.7	1567	61.7	1567
Weight w/o bit (lb & kg)	446	203	446	203
Backhead across flats (in)	2 x 5 7/8 AF		2 x 5 7/8 AF	
Minimum bit size (in & mm)	7.9	200	7.9	200
Maximum bit size (in & mm)	12.0	305	12.0	305
Bore (in & mm)	5.9	149	5.9	149
Piston weight (lb & kg)	112	51	117	53
Stroke (in & mm)	3.75	95	2.75	70
Maximum pressure differential (psig & bar)	350	25	350	25
Maximum choke diameter (in & mm)	0.50	12.7	0.50	12.7
Make-up torque (ft-lb & N-m)	8000	10832	8000	10832
Shank style	QL80		QL80	

Air Consumption:

	Standard		Soft Rock/HF	
	English	Metric	English	Metric
100 psi/ 6.9 bar (scfm & l/s)	391	184	331	156
blows per minute	866		1,242	
150 psi/ 10.3 bar (scfm & l/s)	505	238	559	264
blows per minute	966		1,282	
200 psi/ 13.8 bar (scfm & l/s)	680	321	784	370
blows per minute	1,058		1,333	
250 psi/ 17.2 bar (scfm & l/s)	915	432	1,006	475
blows per minute	1,141		1,396	
300 psi/ 20.7 bar (scfm & l/s)	1,211	571	1,225	578
blows per minute	1,216		1,469	
350 psi/ 24.1 bar (scfm & l/s)	1,568	740	1,441	680
blows per minute	1,283		1,552	